

BOUNDARY GARD™

External detection technology without boundaries

Product update April 2010 Wireless Products

Receiver and Repeater Guide

**Save Time,
Save Energy.
"GO WIRELESS"**



optex-europe.com

Email - sales@optex-europe.com
Tel - 01628 631000

BOUNDARY GARD™

External detection technology without boundaries

Additional Receiver/Repeater options compatible with BoundaryGard

VX402RTI

HX40RAMTI

BX80NRTI

AX100TFRTI

AX200TFRTI

EE4216M (Inovonics)

16 Channel receiver with 9 open collector outputs

- Channels can be mapped to common outputs
- Outputs are programmable for duration
- LCD event display

For full details see specification sheet

EE5000 (Inovonics)

Repeater for servicing multiple receivers.

Requires 10-24V power supply

For full details see specification sheet

For more details regarding availability and pricing please contact our office on 01628 631000

BOUNDARY GARD™

External detection technology without boundaries

Typical RTI wireless receiver configuration

Battery powered independence
No mains power is required for detection device

AX100/200TFRTI

Alarm output (Dome preset 1)
Tamper output (Dome preset 2)
Sensor low battery output
Supervisory output

VX402RTI

Alarm output (Dome preset 3)
Tamper output (Dome preset 4)
Sensor low battery output
Supervisory output

HX40RAMTI

Alarm output (Dome preset 5)
Anti mask output (Audio Alarm)
Tamper output (Dome preset 6)
Sensor low battery output

BX80NRTI

Alarm output (Dome preset 7)
Tamper output (Dome preset 8)
Sensor low battery output
Supervisory output

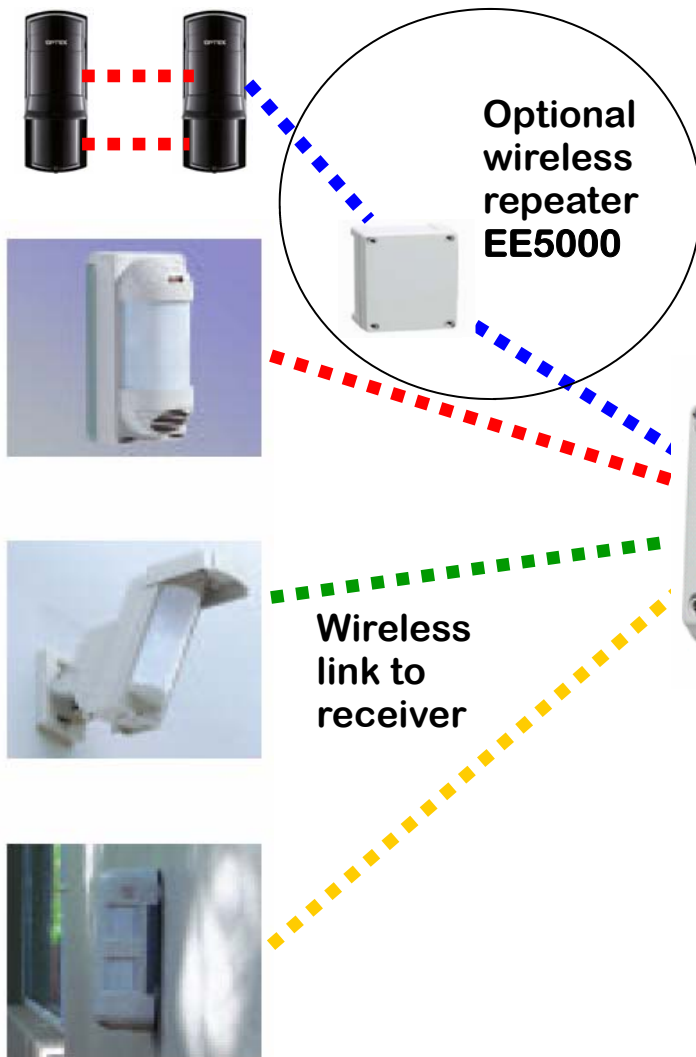

EE4216M (Inovonics) Set up example

16 Channel receiver with 9 open collector outputs

